

BATEDEIRA MORDENTE

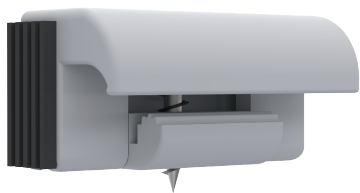

APLICAÇÃO

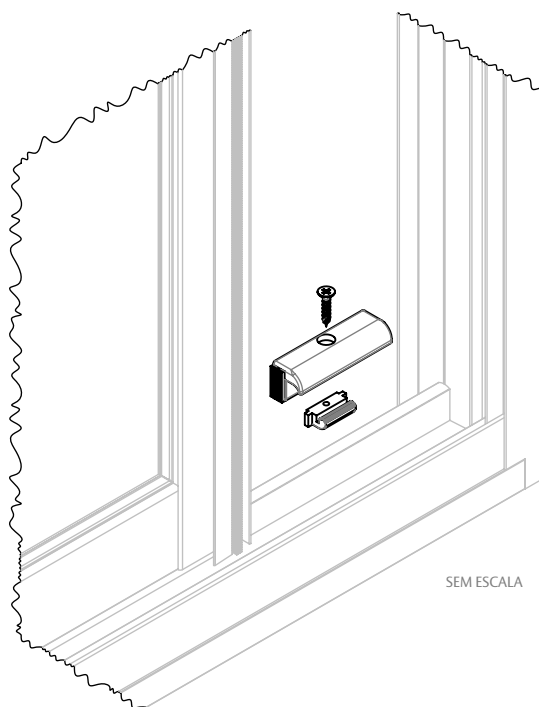

CARACTERÍSTICAS

CODIFICAÇÃO			
VERSÃO	COR	CÓDIGO	CATÁLOGO
40	BCO	9302564	BATMORD40BCOE8
	PRT	9302565	BATMORD40PRTE8
60	BCO	9302566	BATMORD60BCOE8
	PRT	9302567	BATMORD60PRTE8

OBSERVAÇÕES

COMPOSIÇÃO/CARACTERÍSTICAS:

- BATEDEIRA/ MORDENTE: POLÍMERO;
- PARAFUSO: AÇO INOX.

DIMENSÕES

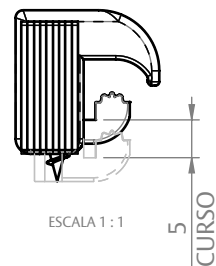
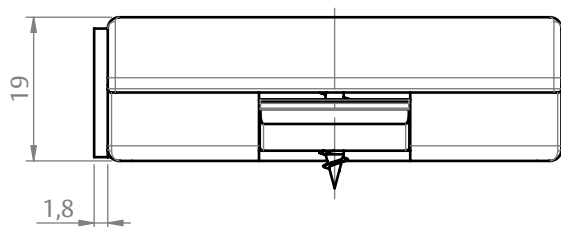

DIMENSÕES "A"
40
60

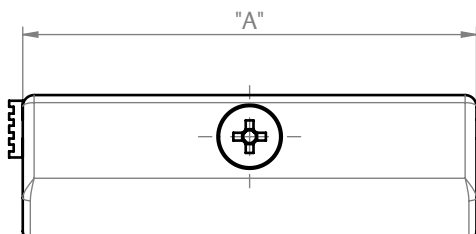

PORTA E JANELA
DE CORRER

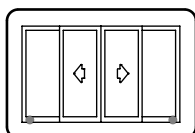

UDINESE
ASSA ABLOY

BATEDEIRA MORDENTE

APLICAÇÕES (LINHA 20)

UNNION
(PERFIL ALUMÍNIO)

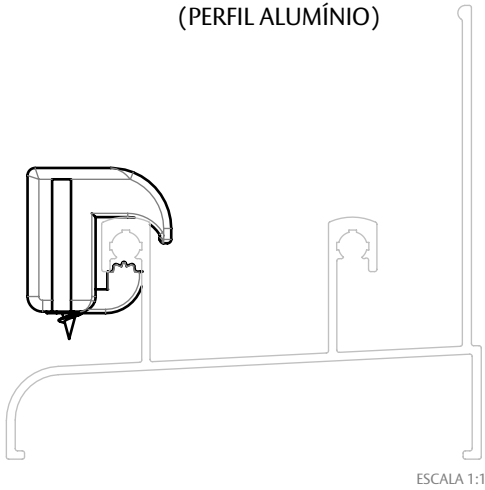

MASTER
(HYDRO)

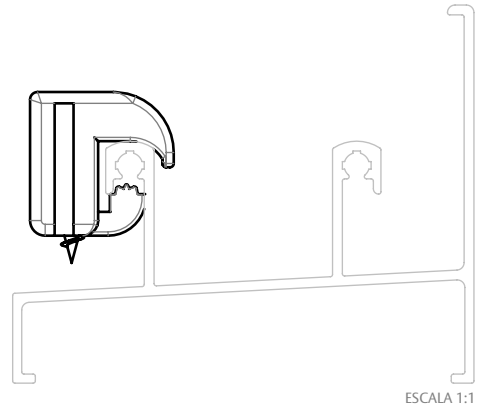

LUNA
(HYDRO)

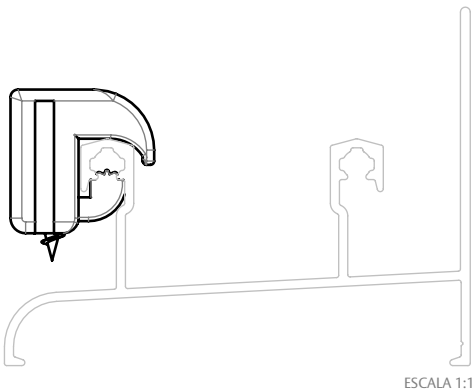

MEGA 20
(ASA ALUMÍNIO)

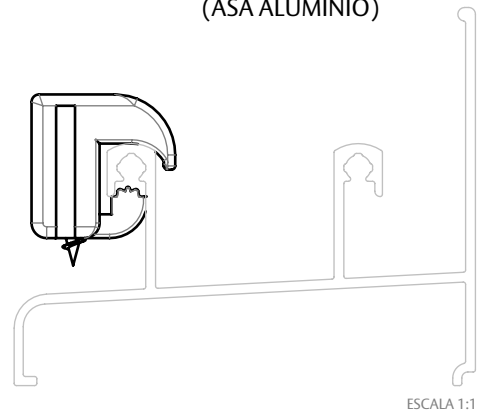

SMART 2.0
(BELMETAL)

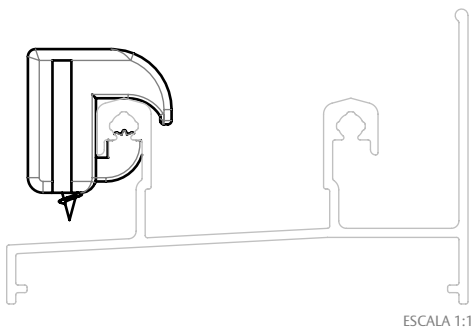

CLASSIC
(BELMETAL)

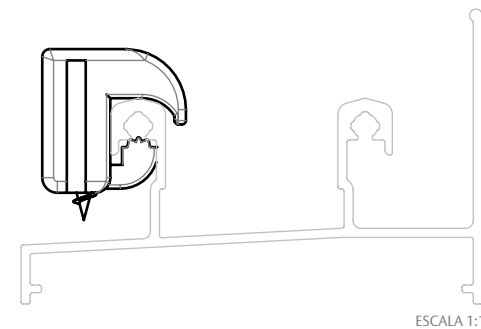

RESERVAMOS O DIREITO DE ALTERAÇÕES SEM AVISO PRÉVIO. TODAS AS MEDIDAS EM mm. IMAGENS MERAMENTE ILUSTRATIVAS.

BATEDEIRA MORDENTE

APLICAÇÕES (LINHA 25)

ECOLINE 2.5
(PERFIL ALUMÍNIO)

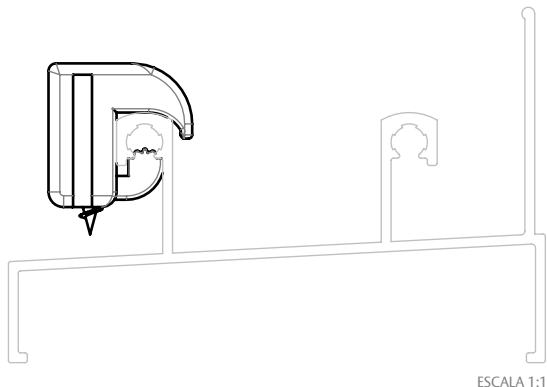

SUPREMA
(HYDRO)

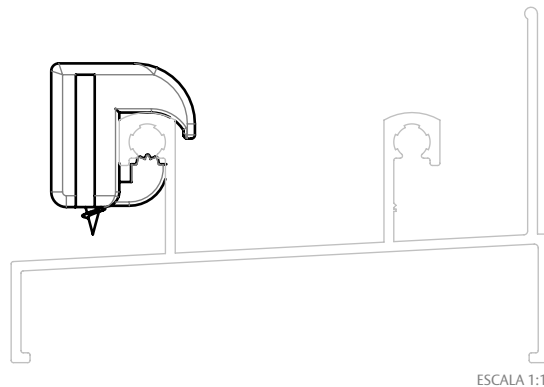

MEGA 25
(ASA ALUMÍNIO)

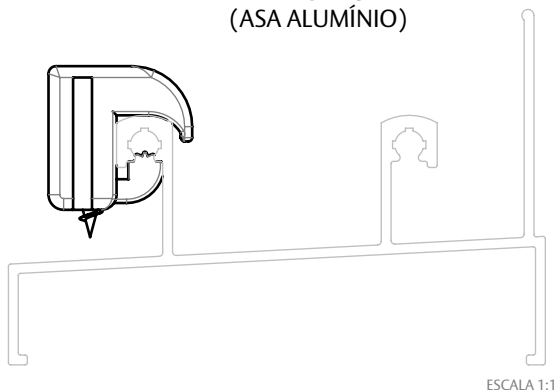

IMPERIAL 2.5
(BELMETAL)

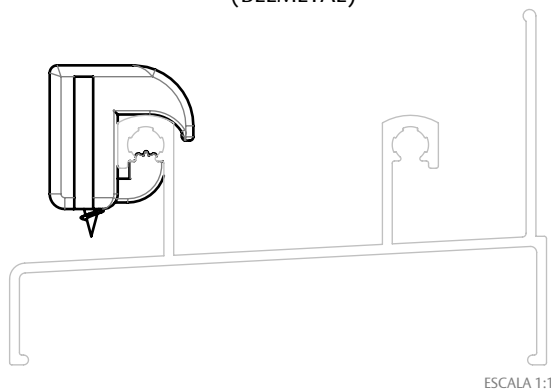

AGLO 25
(OLGA COLOR)

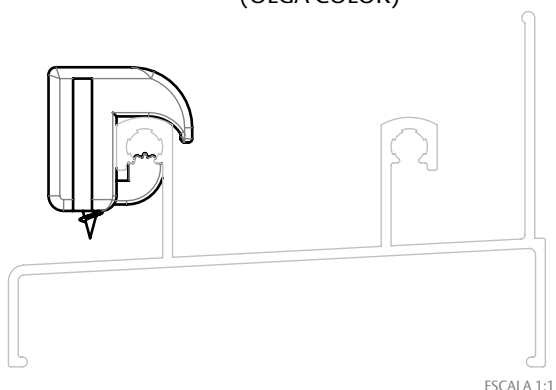

ABSOLUTA
(CDA ALUMIGON)

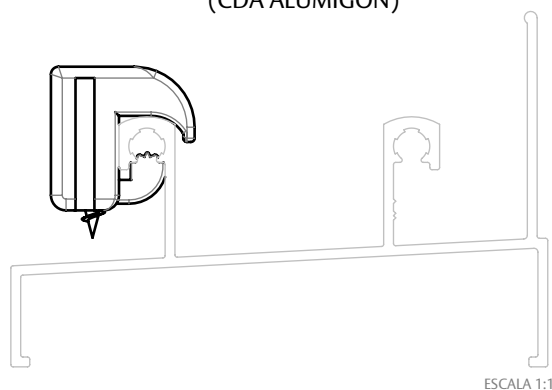

OFFICIAL
(HYDRO)

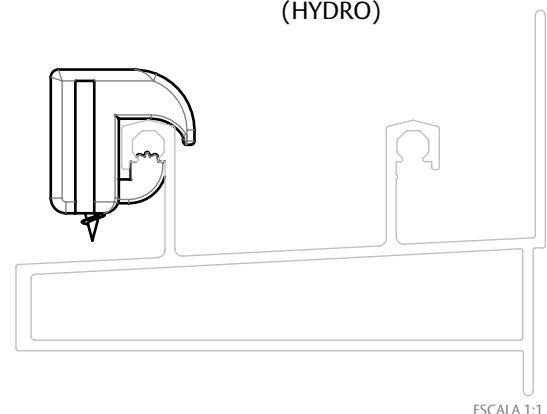

RESERVAMOS O DIREITO DE ALTERAÇÕES SEM AVISO PRÉVIO. TODAS AS MEDIDAS EM mm. IMAGENS MERAMENTE ILLUSTRATIVAS.

UDINESE
ASSA ABLOY