

DOBRADIÇA 780/R

APLICAÇÃO

LINHA 30

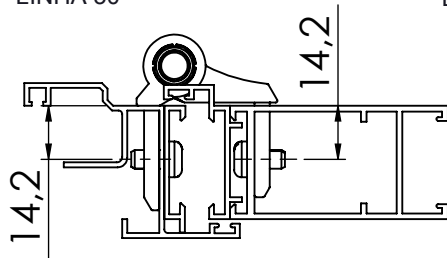

LINHA 30 INVERTIDA

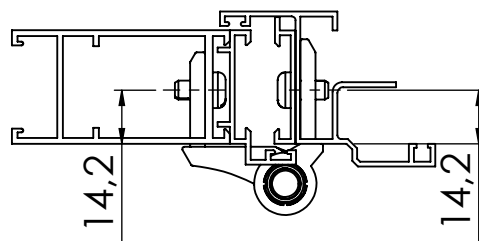

CARACTERÍSTICAS

EMBALAGEM

COMPONENTES	M. PRIMA	QTDE
DOBRADIÇAS	ALUMÍNIO	6
BUCHAS	POLÍMERO	12
EIXO	ALUMÍNIO	3
PARAFUSOS	INOX	3

CODIFICAÇÃO

COR	CÓDIGO	CATÁLOGO
BCO	9300941	DOB780RBCOE3
BP3	9302239	DOB780RBP3E3
PRA	9302216	DOB780RPRAE3
PTF	9302167	DOB780RPTFE3

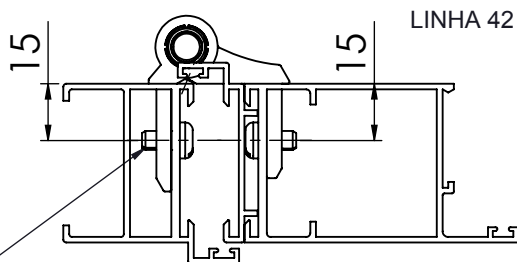

LINHA 42

Parafuso 4,2mm
auto atarraxante não fornecido
pela Udinese

Obs.: Carga máxima por folha =90Kg (Utilizando 3 dobradiças por folha).

Dimensões máxima da folha para aplicação
L=1100 x H=2300 mm.

DIMENSÕES DE REFERÊNCIA

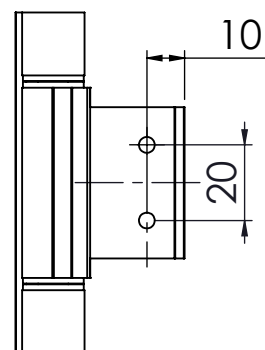
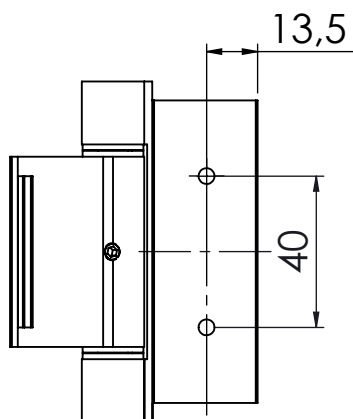

PORTA DE GIRO
CONVENCIONAL

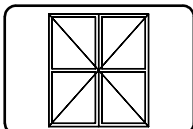

UDINESE
ASSA ABLOY

DOBRADIÇA 780/R

POSIÇÃO DE MONTAGEM

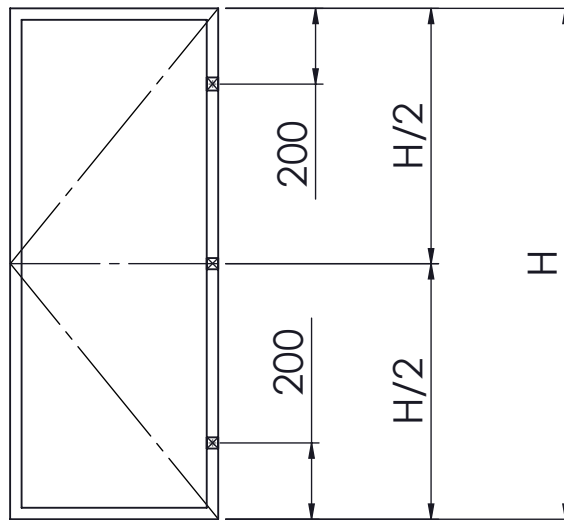

DETALHE DE USINAGEM DAS ABAS

LINHA 30

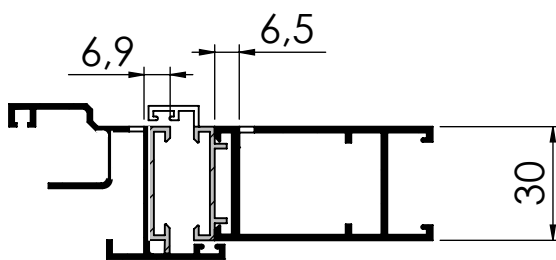

SEÇÃO A-A

LINHA 42

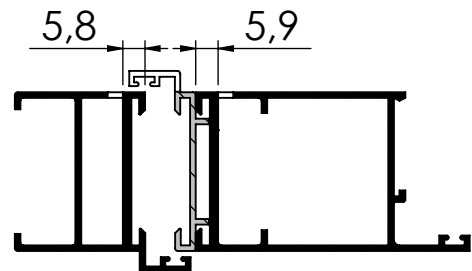

SEÇÃO B-B

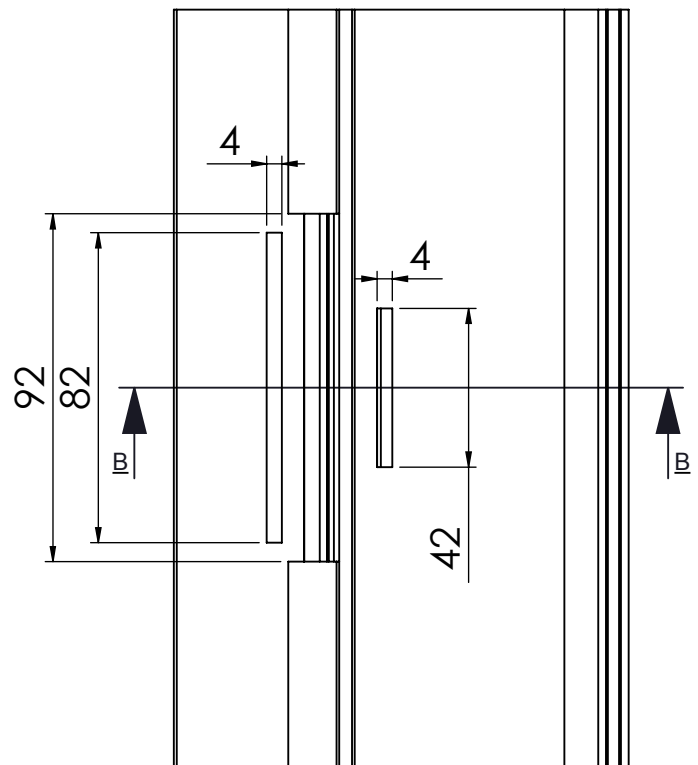
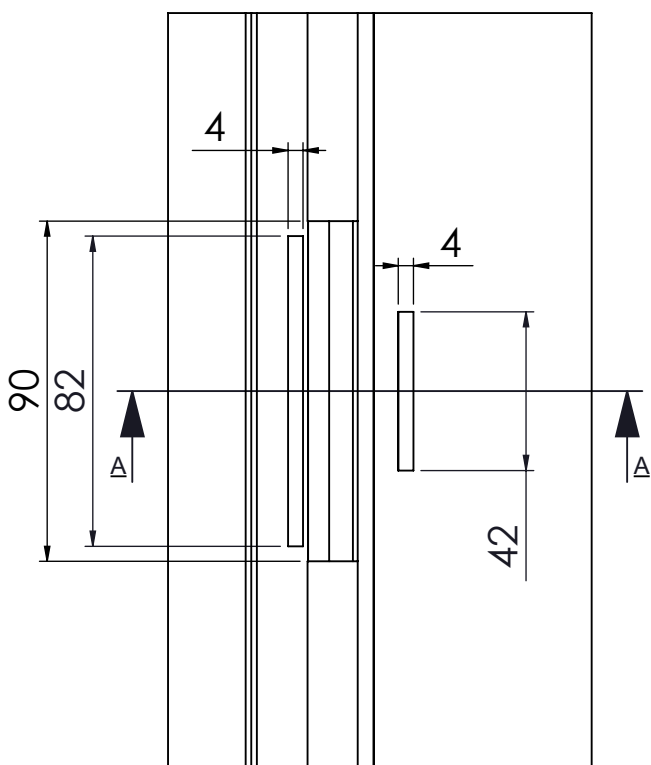

ESCALA 1 : 2

UDINESE
ASSA ABLOY