

FECHO CONCHA FLARE 220 LINGUETA

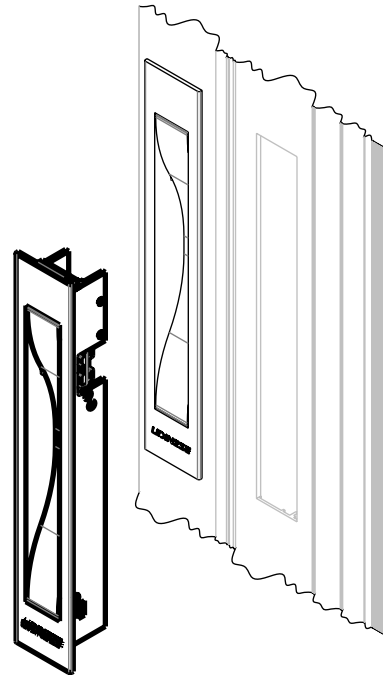

APLICAÇÃO



CARACTERÍSTICAS

CODIFICAÇÃO		
COR	CÓDIGO	CATÁLOGO
BCO	9209241	CONFLARE220LINBCO
INX	9210320	CONFLARE220LININX
PRA	9209939	CONFLARE220LINPRA
PTF	9209242	CONFLARE220LINPTF
S/A	9211618	CONFLARE220LINS/A

OBSERVAÇÕES

COMPOSIÇÃO/CARACTERÍSTICAS:

- ESTRUTURA E PINOS: ALUMÍNIO;
- MECANISMO: ALUMÍNIO/POLÍMERO;
- MOLA: AÇO INOX.

DIMENSÕES

USINAGENS

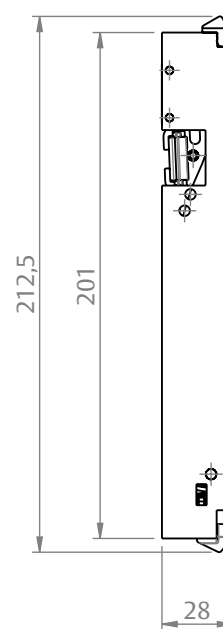
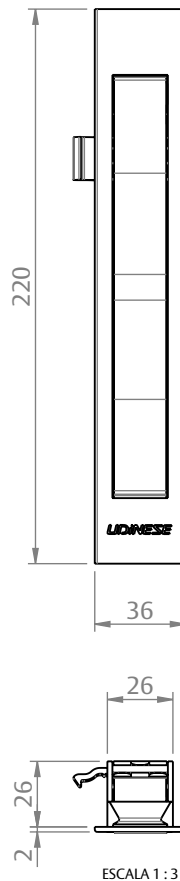
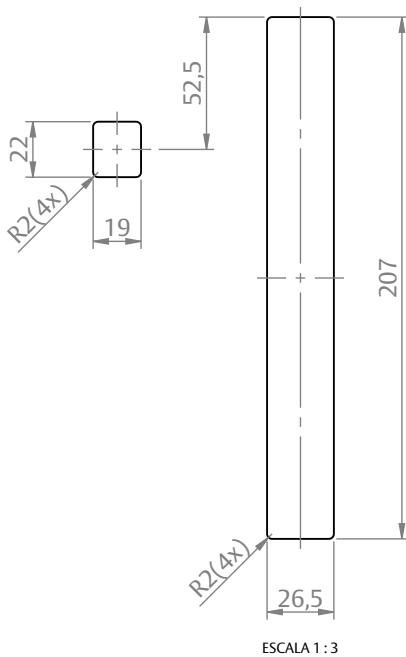

PORTA E JANELA
DE CORRER
LINHA FLARE

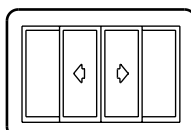

UDINESE
ASSA ABLOY

FECHO CONCHA FLARE 220 COM CHAVE LINGUETA



APLICAÇÃO

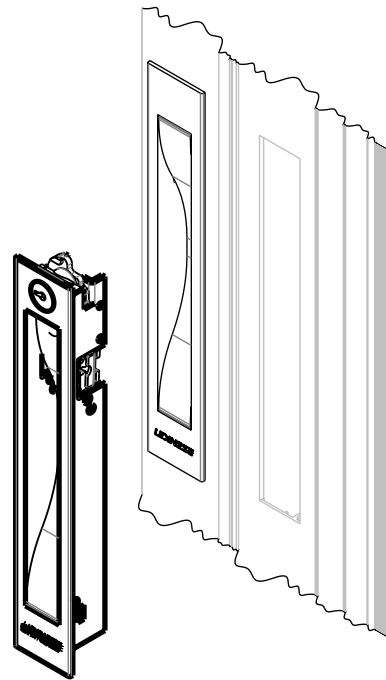

CARACTERÍSTICAS

CODIFICAÇÃO		
COR	CÓDIGO	CATÁLOGO
BCO	9209894	CONFLARE220CLINBCO
INX	9210321	CONFLARE220CLININX
PTF	9209895	CONFLARE220CLINPTF
S/A	9211619	CONFLARE220CLINS/A

OBSERVAÇÕES

COMPOSIÇÃO/CARACTERÍSTICAS:

- ESTRUTURA E PINOS: ALUMÍNIO;
- MECANISMO: ALUMÍNIO/POLÍMERO;
- MOLA: AÇO INOX.

DIMENSÕES

USINAGENS

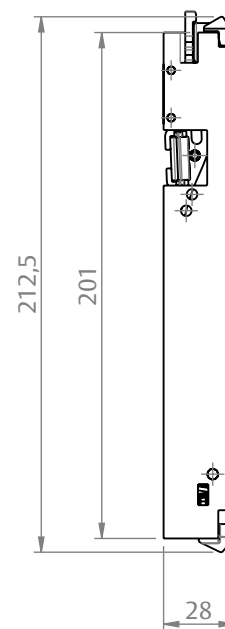
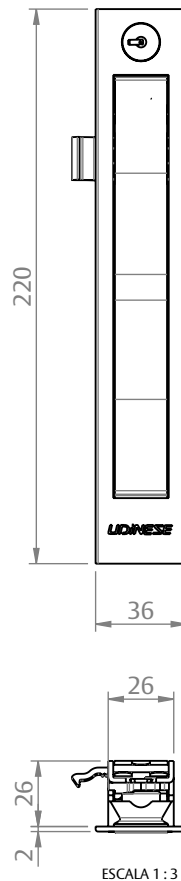
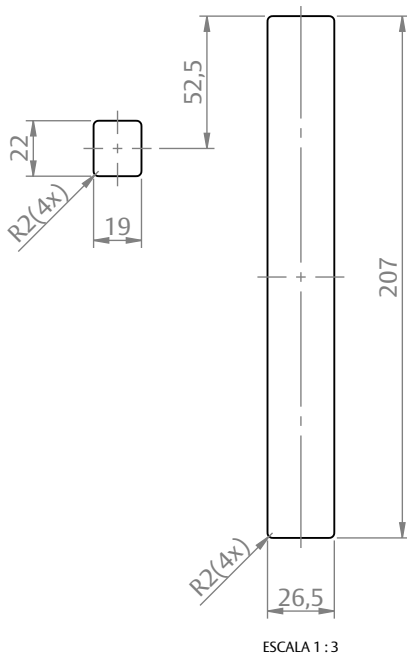

PORTA E JANELA
DE CORRER
LINHA FLARE

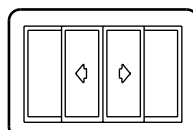

UDINESE
ASSA ABLOY

FECHO CONCHA FLARE 220

MONTAGEM

1. Para realizar o encaixe da Concha no perfil o posicionamento inicial se dá pelo lado oposto a mola de fixação.

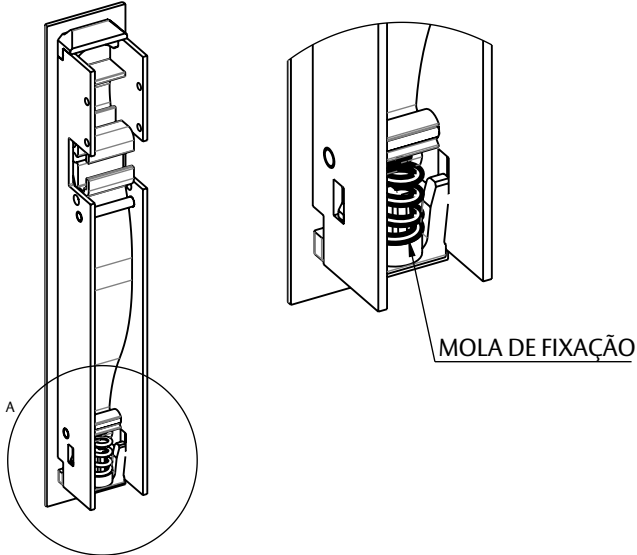

2. Pressionar a extremidade da Concha que não possui a mola contra a parede da usinagem do perfil (F1). Em seguida, pressionar a outra extremidade contra o perfil da esquadrinha (F2) até que seja feito o encaixe como mostra a figura ao lado.

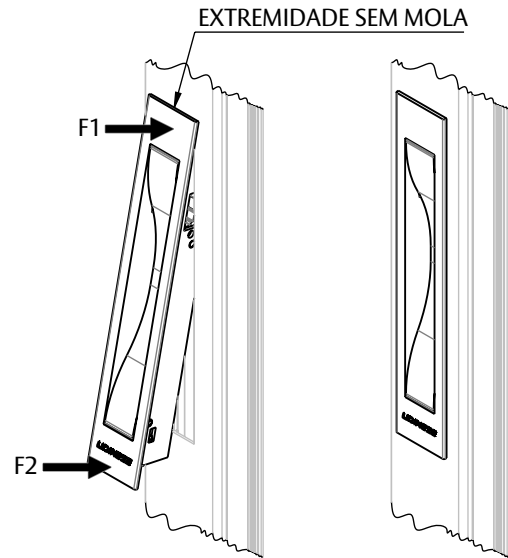

3. Realizar o posicionamento exato da Lingueta na Trava Dentada em relação a perfeita distância do Contra Fecho.

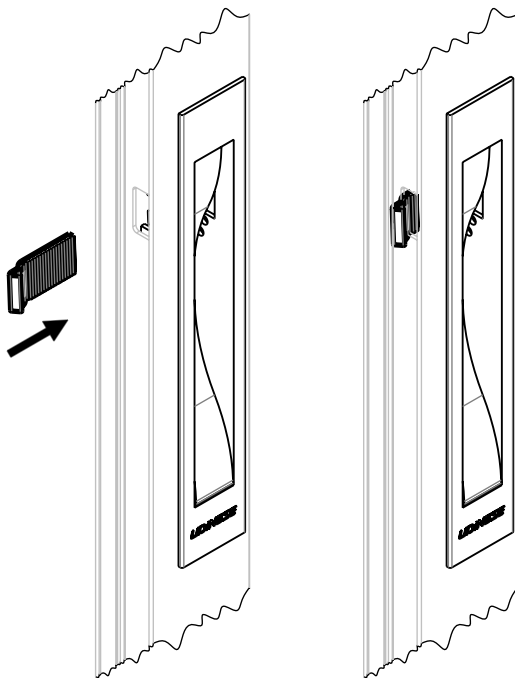

4. Apertar o Parafuso Allen Sem Cabeça M5 para fixar a Lingueta na posição desejada.

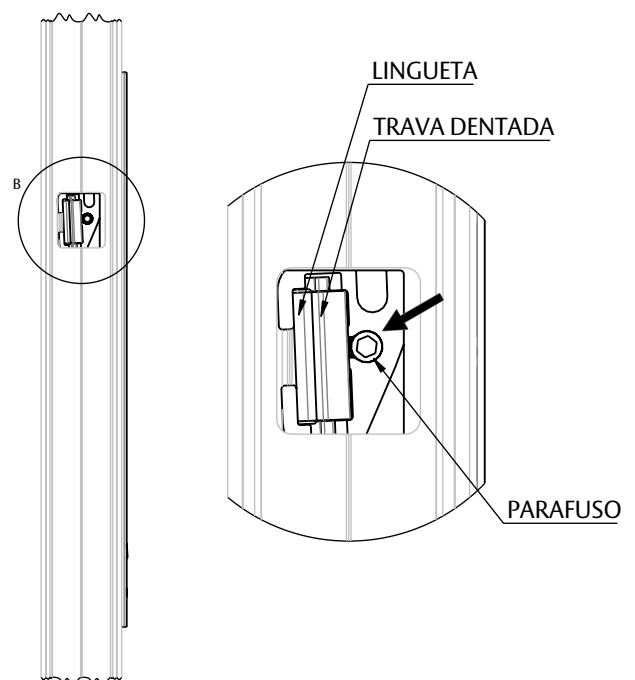

UDINESE
ASSA ABLOY

FECHO CONCHA FLARE 220

APLICAÇÕES

GOLD (HYDRO)

FECHAMENTO CENTRAL

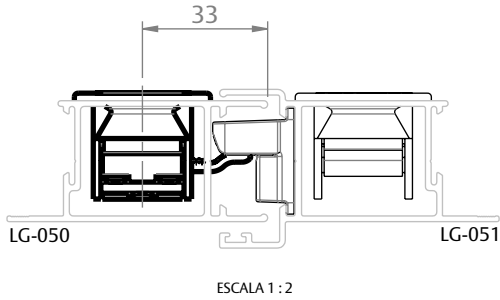

FECHAMENTO LATERAL

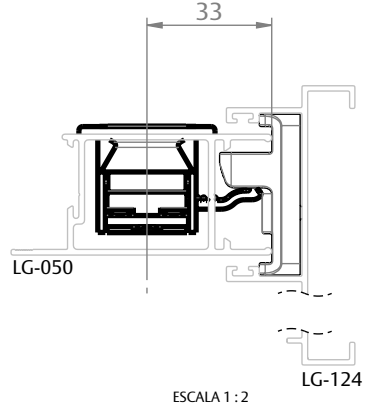

MEGA 32 (ASA ALUMÍNIO)

FECHAMENTO CENTRAL

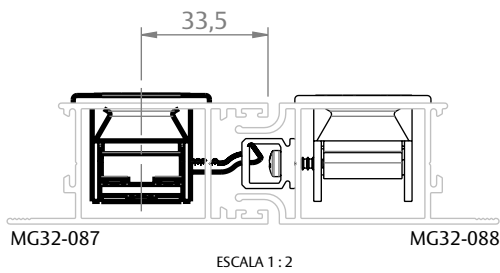

FECHAMENTO LATERAL

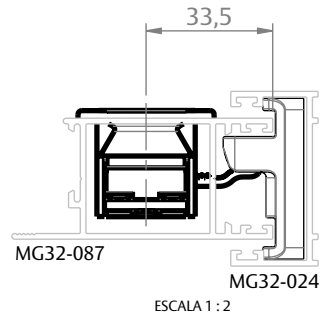

D'ORO (CDA ALUMIGNON)

FECHAMENTO CENTRAL

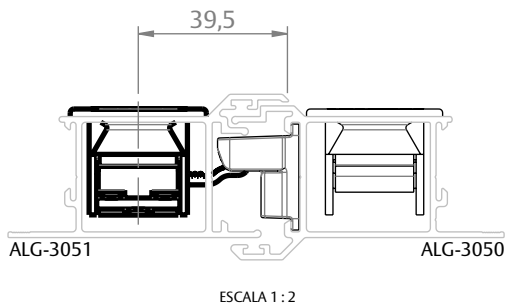

FECHAMENTO LATERAL

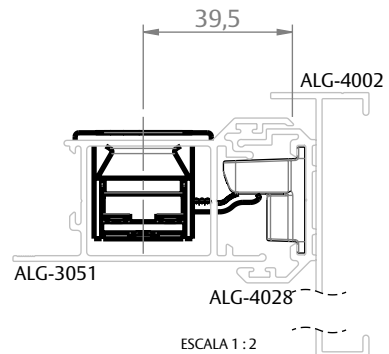

FECHO CONCHA FLARE 220

APLICAÇÕES

IMPERIAL SLIM (BELMETAL)

FECHAMENTO CENTRAL

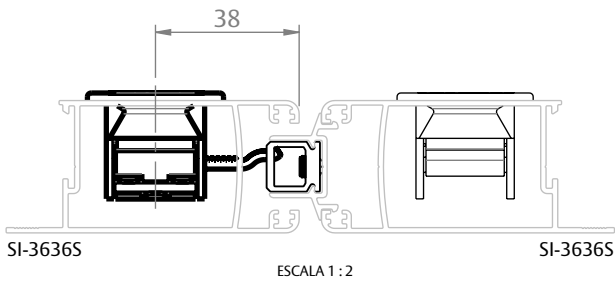

FECHAMENTO LATERAL

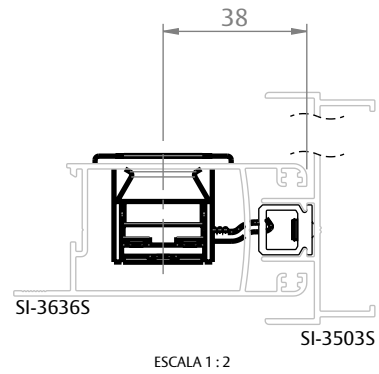

IMPERIAL 3.5 COM BAGUETE (BELMETAL)

FECHAMENTO CENTRAL

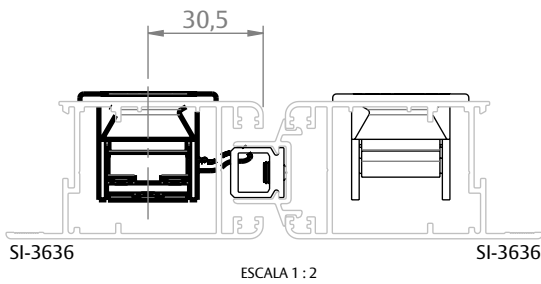

FECHAMENTO LATERAL

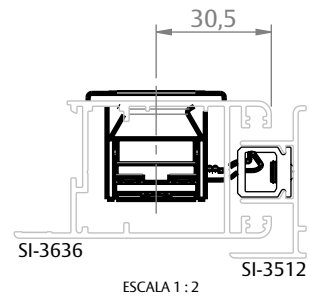

IMPERIAL 3.5 SEM BAGUETE (BELMETAL)

FECHAMENTO CENTRAL

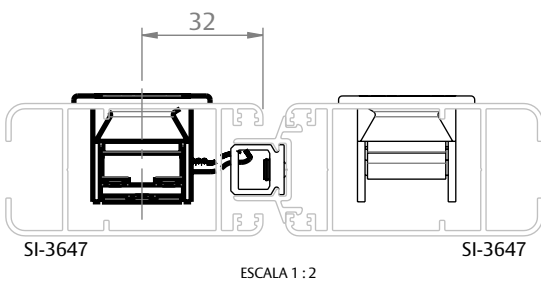

FECHAMENTO LATERAL

